

BANEASA - Large 3 bedrooms apartment
90sqm terrace

2,000 € / lună



GENERAL INFORMATION

- 4 rooms
- level: 1 / 1S+P+3E
- construction year: 2007

AREAS

- built: 337 sqm
- usable: 228 sqm

CONTAINS

- 3 bedrooms
- 3 bathrooms

Utilities

air conditioning, stove, shower, bathtub, fridge, kitchen hood, washing machine, fireplace, unfurnished, central heating, furnished kitchen, water meters, heating meter

Property details

In the heart of Baneasa forest, surrounded by greenery and peaceful atmosphere, this 1st floor apartment is located in a closed private area of 2000 sqm with playground for children and outside parking lots. The apartment has a usable area of 228 sqm with 90sqm terrace and has 2 outside parking lots. It is composed of a generous living room with fireplace and dining area, equipped kitchen, office/bedroom, guest toilet and 2 bedrooms with dressing and en suite bathrooms. It is 10 minutes driving distance to Baneasa Shopping Center and Otopeni airport, 5 minutes driving to the French School and 25 minutes driving to the city center.

<https://ct.goldenkey.ro/en/property-large-3-bedrooms-apartment-90sqm-terrace-cp8972>

RELEVU
SC. 1:100

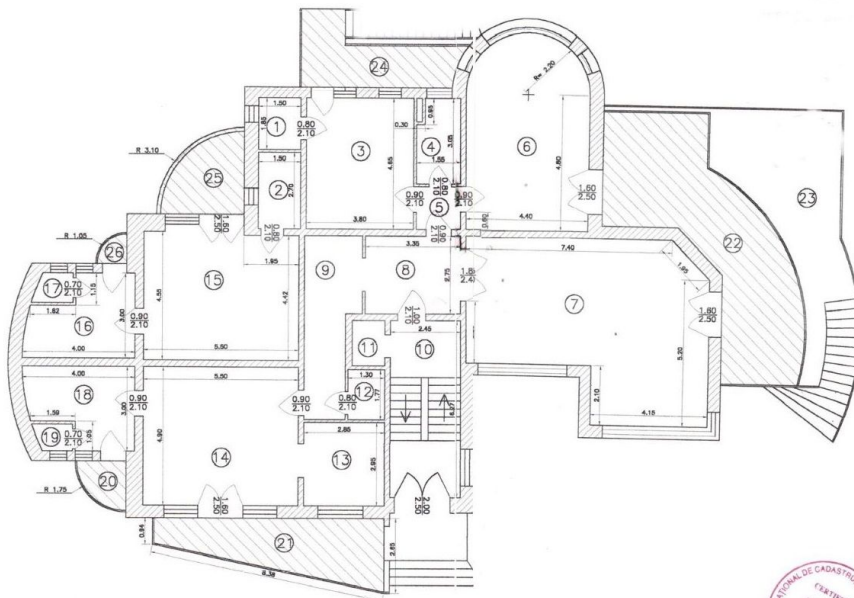

RECAPITULATIE

Numar curent	Destinatie	Supraf	UTIL
1	CAMARA	2.78	*
2	DEBARA	4.05	*
3	BUCATARIE	17.67	*
4	BAIE	4.44	*
5	SAS	2.48	*
6	CAMERA	28.67	*
7	CAMERA	47.14	*
8	HOL	9.76	*
9	HOL	10.65	*
10	HOL	15.36	*
11	ASCENSOR	1.84	
12	DEBARA	2.30	*
13	CAMERA	8.41	*
14	CAMERA	26.95	*
15	CAMERA	25.38	*
16	BAIE	9.62	*
17	WC	1.36	*
18	BAIE	9.78	*
19	WC	1.21	*
20	TERASA	2.41	
21	TERASA	14.72	
22	TERASA	34.36	
23	TERASA SI SCARA	31.18	
24	TERASA SI SCARA	16.50	
25	TERASA	7.52	
26	TERASA	0.85	

SUPRAFATA TOTALA = 337.39 mp

SUPRAFATA UTILA = 228.01 mp