

**FLOREASCA - Verdi Park**  
4 rooms

**919,000 €**

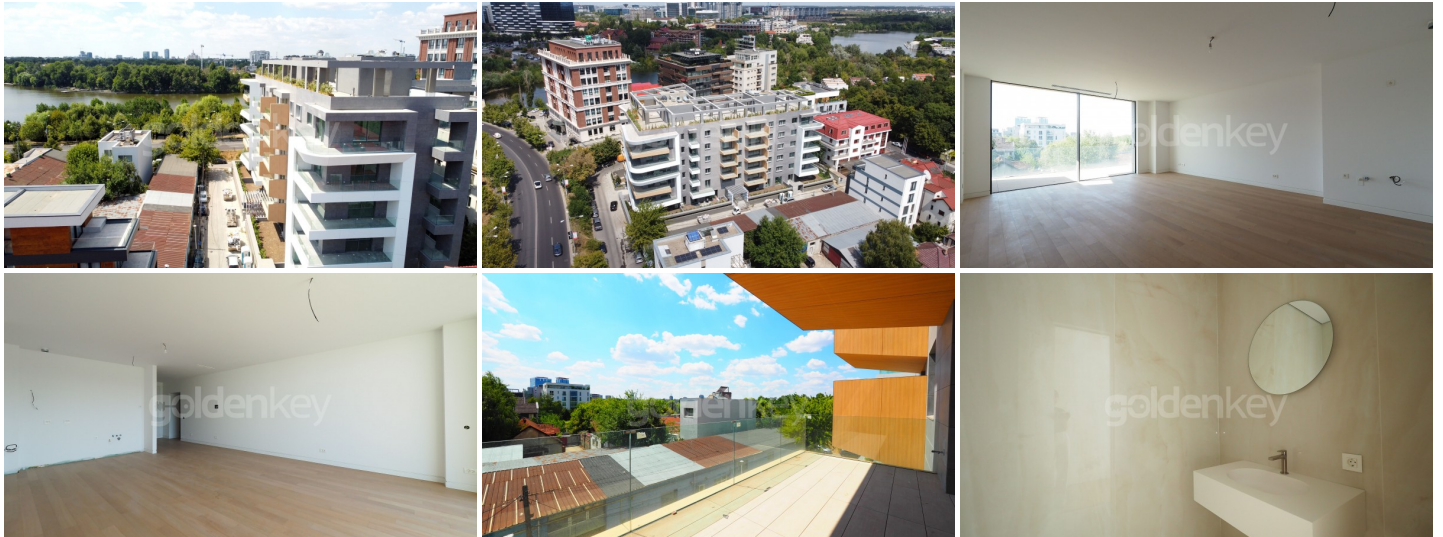

**GENERAL INFORMATION**

- 4 rooms
- level: 2 / 2S+P+5E
- construction year: 2023

**AREAS**

- built: 181 sqm
- usable: 122 sqm

**CONTAINS**

- 3 bedrooms
- 3 bathrooms

**Utilities**

air conditioning, central heating, underfloor heating, water meters, heating meter, electricity meter, elevator, service closet

**Property details**

On the shores of Lake Floreasca, with spectacular views of it, the building 2S + P + 5 consists of 35 residential units with 2-6 rooms divided by 2 stairs. The apartments have large glazed surfaces, lake views, generous surfaces and are sunny due to the south-east-west orientation. Located on the 2nd floor, this apartment has a built area of 181sqm of which 122sqm usable and 25sqm terrace. It consists of a generous living room with dining area, kitchen, 17 sqm terrace, toilet, master bedroom with private bathroom and dressing room, and 2 secondary bedrooms with bathroom and terrace 10sqm. The finishing and materials used are top (aluminum joinery, ventilated façade, underfloor heating) from industry leading manufacturers. The unique location on the lakeside, the exceptional quality of the construction and proximity of the Floreasca office pole-Promenade Mall-Aurel Vlaicu, modern facilities, make the residential experience at the highest level.

<https://ct.goldenkey.ro/en/property-verdi-park-4-rooms-3-baths-generous-terraces-floreasca-lake-cp767005>

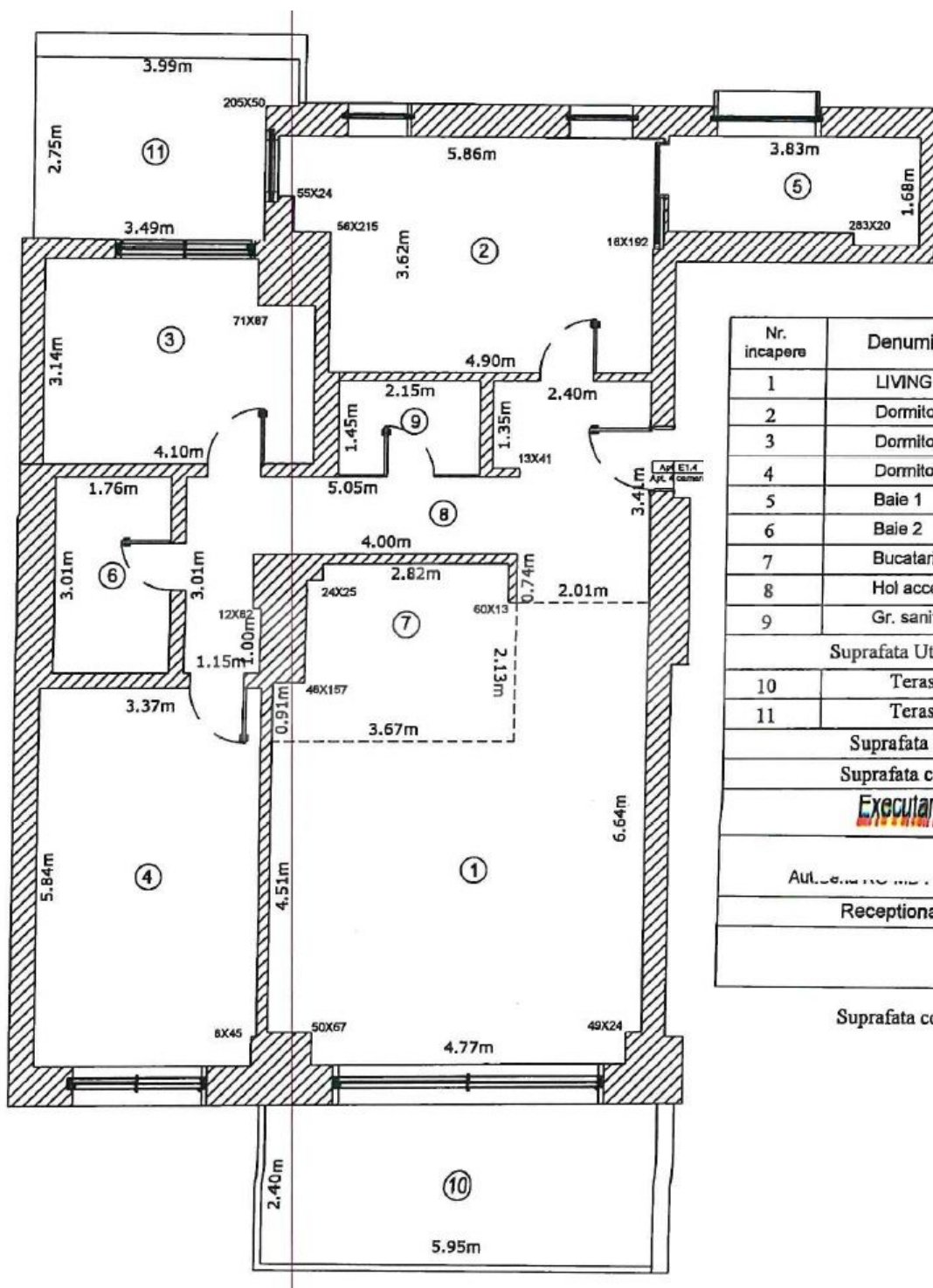

Nr. incapere	Denumire incapere	Suprafata utila (mp)
1	LIVING + DINNING	32.2
2	Dormitor 1	19.0
3	Dormitor 2	12.2
4	Dormitor 3	19.6
5	Baie 1	5.9
6	Baie 2	5.3
7	Bucatarie	9.0
8	Hol acces	15.4
9	Gr. sanitar	3.1
Suprafata Utila = 121.7 mp		
10	Terasa	14.3
11	Terasa	9.9
Suprafata Totala = 145.9 mp		
Suprafata construita = 150 mp		
<b>Executant,</b>		<i>Data</i>
Aut. semn. nr. mp. / ...		Ian 2026
<b>Receptionat,</b>		<i>Data</i>

Suprafata construita terasa = 28.1 mp